

# MAP

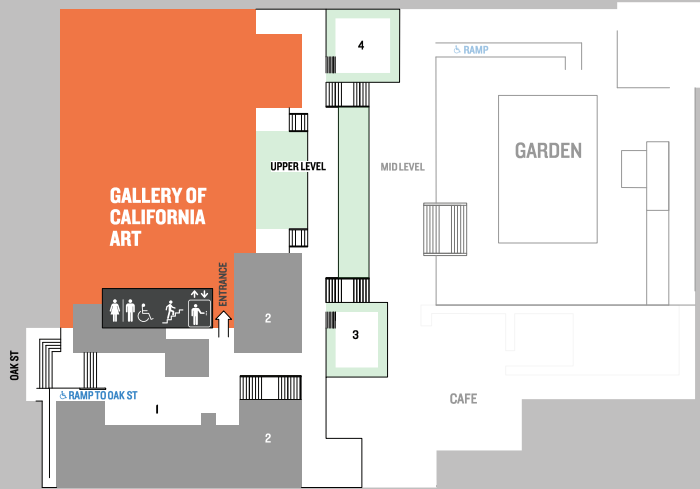

|             |                  |
|-------------|------------------|
| UPPER LEVEL | ART              |
| MID LEVEL   | HISTORY          |
| LOWER LEVEL | NATURAL SCIENCES |

## UPPER LEVEL

Gallery of California Art

1. Oak Street Plaza
2. Offices
3. Glimmer Terrace
4. Peace Terrace

[Accessible ramp to Oak Street](#)

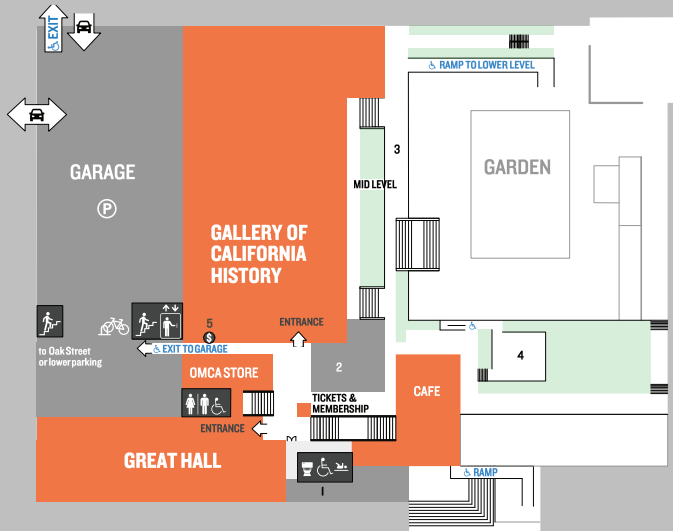

## MID LEVEL

Tickets & Membership  
 Gallery of California History  
 Great Hall  
 OMCA Store  
 Cafe  
 Garage

1. All Gender Restrooms
1. Family Restroom
2. Offices
3. Terrace
4. Patio
5. Pay for parking

[Accessible route to Garage](#)

[Accessible ramp to Garden](#)

[Accessible ramp from Cafe to 10th Street](#)

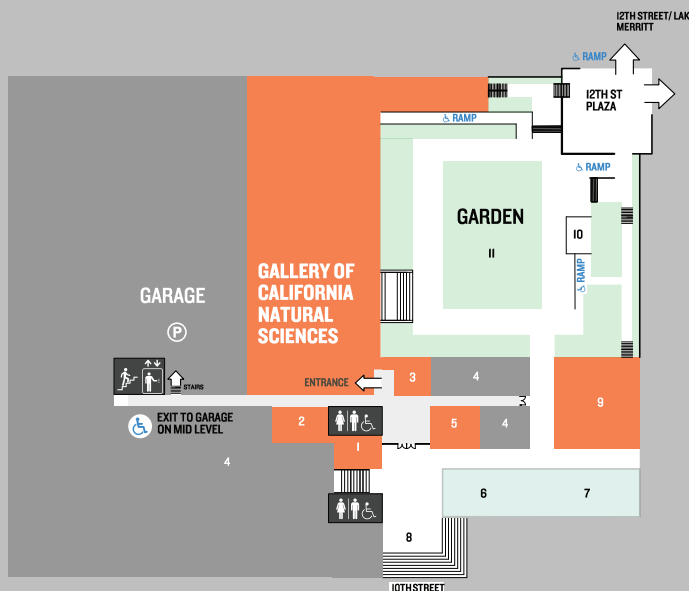

## LOWER LEVEL

Gallery of California Natural Sciences  
 Garden  
 Garage

1. California Room
2. Lecture Hall
3. Volunteer Center
4. Offices
5. Learning Center
6. Koi Pond
7. Turtle Pond
8. 10th St Amphitheater
9. James Moore Theater
10. Main Stage
11. Great Lawn

[Accessible exit to 12th Street](#)